

OVERALL DIMENSIONS

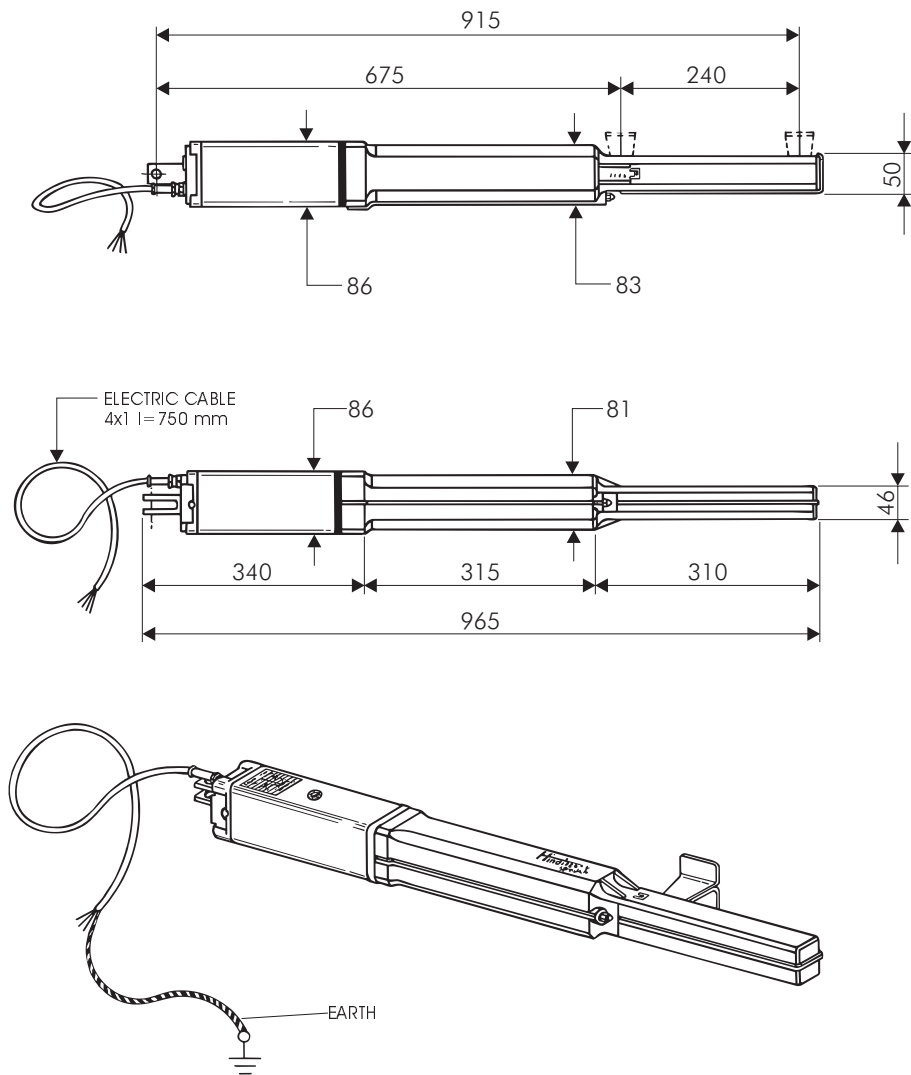

GB

"HINDI 880 Sprint" is specifically designed to open and close swinging gates. It is operated by 230 V through an electronic control panel (with the options automatic or semi-automatic) which is designed for the connections of the following accessories: remote control set, photocells for safety and keyswitch with a custom-made key profile.

All you need to install this operator are two fixing brackets - one to the gate and one to the gate post - and two retaining pins that are supplied with the equipment along with an installation manual having diagrams and application drawings to make the job all that simple. The essential parts (i.e. piston, pump, electric motor and valve assembly) are in a reservoir filled with special oil, particularly suitable for the harsh temperature conditions, deeply low or very high, the operator is required to withstand on the installation site. The manual release is under the valve assembly, within easy reach and of quick response in events like power failure when it is required to push the gates open by hand. The safeguard of living beings and properties, anti-crush, is ensured by specially designed devices in the valve body. These are two built-in safety pressure valves, one in the hydraulic circuit open and one in the hydraulic circuit close. These also ensure a constant and consistent thrust/pushing power both in open and close cycles. The valves, the piston and the shaft are protected by a cover made of thick pressure cast aluminium, epoxy painted, shock resistant, weather-proof and vandal-proof. Oil pressure in both open and close circuits is ensured by a "lobe" pump made of steel, very quiet, machined with specially designed tools. It is coupled to the shaft of the motor which rotates clockwise and anti clockwise to pump oil in the hydraulic circuits. This operator is suitable for gates up to 1.80 m each. The opening time is 18 seconds. It has an improved design of its engineering features (specially the pressurized oil circuit) and being linear in its shape and mounting, the pushing power it can develop is transmitted along the axis, i.e. the centre line of the fixings to the gate and gate post. Manufactured in the workshops of Meccanica Fadini, "HINDI 880 Sprint" is an extremely reliable unit thanks to the precise engineering principles, the quality control system and the accurate thermal treatment of all the moving parts.

TECHNICAL SPECIFICATION

Oil-hydraulic piston and hydraulic pump

Time for one stroke	18 s
Pump flow rate - P5	1.4 l /min.
Stroke	240 mm
Piston diameter	45 mm
Shaft diameter	16 mm
Thrust power. Open	2'180 N
Thrust power. Close	2'380 N
Average working pressure	1 MPa (10 bars)
Max. pump pressure	3 MPa (30 bars)
Type of hydraulic oil	A 15 FADINI by AGIP
Working temperature	- 25°C + 80°C
Weight with accessories	9.5 Kg
Max. weight of the gate	120 Kg
Protection standards	IP 553
Overall dimensions (LxWxH)	965x86x86 mm

Electric motor

Power output	0.18 KW (0.25 HP)
Supply voltage	230 V
Frequency	50 Hz
Absorbed power	250 W
Absorbed current	1.2 A
Motor rotation speed	1'350 r.p.m.
Capacitor	12.5 µF
Intermittent service	S 3

Duty cycle 18 s Opening - 60 s Stop - 18 s Closing
 Time of one complete cycle 96 s
 No. of complete cycles Opening-Stop-Closing 37/h
 109'000 cycles a year, 8 hours' service a day

CE EUROPEAN MARK CERTIFYING CONFORMITY TO THE ESSENTIAL REQUIREMENTS OF THE STANDARDS 98/37 EC



Drwg. No. 1891

TECHNICAL SPECIFICATION TABLE

OIL-HYDRAULIC GATE OPERATOR ABOVE GROUND